

10 HP

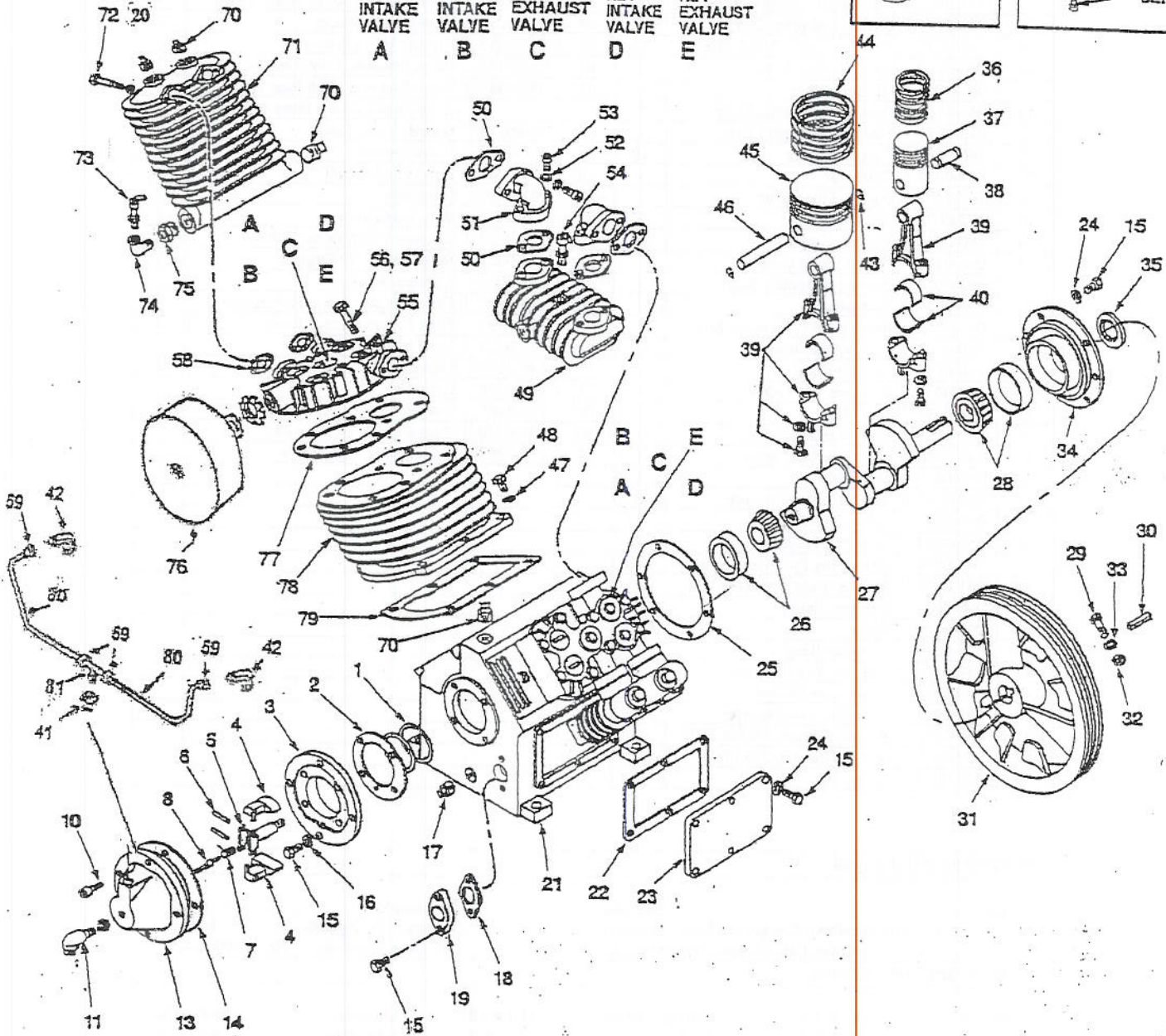
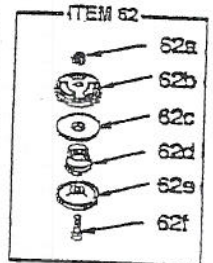
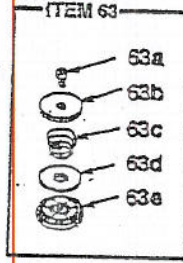
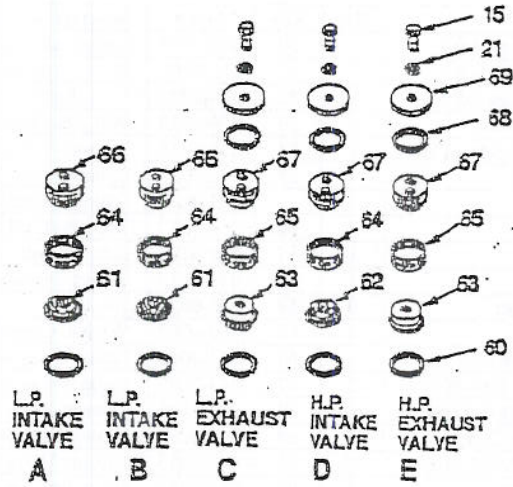
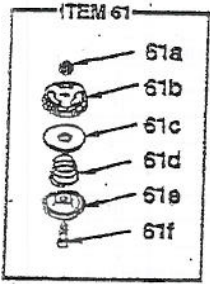

MODEL DF 10; 7.5 & 10 HP

Key	Part #	Description	Qty	Key	Part #	Description	Qty
1	046-0175	Shim, .005 (Bearing Adj.)		50	046-0172	Gasket Aftercooler Manifold	4
	046-0176	Shim, .010 (Bearing Adj.)		51	083-0008	Elbow, Aftercooler Manifold	2
	046-0177	Shim, .015 (Bearing Adj.)		52	060-0070	Lock Washer, 8mm	8
2	046-0227	Gasket, Adapter Plate	1	53	059-0158	Bolt, Manifold, M8x25mm	8
3	077-0070	Centrifugal Unldr Adapt. Plate	1	54	136-0028	Pressure Valve, 225 PSI	1
4	096-0009	Unloader Weight	2	55	042-0055	Cylinder Head (5 & 10HP Common)	1
5	114-0112	Weight Holder	1		042-0056	Cylinder Head (Side Not Shown)	1
6	107-0015	Unloader Pin	2	56	059-0167	Head Bolt, M12x70mm	16
7	114-0113	Unloader Spring	1	57	060-0105	Lock Washer, M12, Type B	16
8	078-0011	Plunger	1	58	046-0173	Gasket, Intercooler	4
9	056-0018	Crankcase Breather	0	59	090-0621	Nut 621	4
10	043-0101	Bolt, M6x22mm	4	60	060-0062	Washer, Copper, 1.62 OD x .017"	10
11	031-0034	Air Valve w/Valve Core	1	61	043-0098	Intake Valve Assy., Low Press.	4
12	058-0081	Mod. Valve Rtnr, 058-0082a	2	62	043-0099	Intake Valve Assy., High Press.	2
13	077-0071	Centrifugal Under Housing	1	63	043-0100	Exhaust Valve Assy., H & L Press.	4
14	046-0171	Gasket, Unloader Cover	1	64	043-0094	Intake Valve Spacer	6
15	059-0153	Hex Cap Screw, M8x25mm	23	65	043-0095	Exhaust Valve Spacer	4
16	060-0070	Lock Washer, 8mm	4	66	058-0082	Valve Retainer, Low Press. Intake	2
17	062-0004	Oil Drain Plug	1	67	058-0083	Valve Retainer, High Press Intake	6
18	046-0178	Gasket, Sight Glass Flange	1			& Exhaust and Low Press. Exhaust	
19	032-0031	Flange With Sight Glass	1	68	046-0174	Gasket, Valve Cover	6
20	060-0637	Copper Washer	10	69	077-0073	Valve Covers	6
21	049-0028	Crankcase	1	70	062-0006	Pipe Plug, 1/4" NPT	7
22	046-0170	Gasket, Side Cover	1	71	082-0012	Intercooler	2
23	077-0072	Side Cover	1	72	059-0157	Bolt, M8x90mm	8
24	060-0061	Washer, Copper	16	73	136-0027	Pressure Relief Valve, 75PSI	2
25	046-0168	Gasket, Front Cover	1	74	064-0022	Street Elbow, 90 Degrees	2
26	051-0054	Bearing Assembly, Rear	1	75	063-0006	Reducer Bushing	2
27	053-0052	Crankshaft	1	76	019-0097	Filter Canister Assy., Rectangular	0
28	051-0053	Bearing Assy, Flywheel End	1		019-0098	Filter Canister Assy., Round	2
29	059-0163	Bolt, M16x80mm	1	76a	019-0023	Filter Element	2
30	146-0015	Key, Flywheel	1	77	046-0166	Gasket, Cylinder /Head	2
31	044-0051	Flywheel, 19" OD	1	78	050-0030	Cylinder	2
32	058-0086	Nut, M16	1	79	046-0167	Gasket, Cylinder/Crankcase	2
33	060-0069	Lock Washer, 16mm	1	80	090-0430	Copper Tube, 10 x 1 x 430	2
34	045-0044	Front Bearing Carrier	1	81	090-3807	T Connector, 090-38074	1
35	046-0179	Seal, Shaft	1				
36	054-0127	Ring Set, High Pressure	2				
37	048-0055	Piston, High Pressure	2				
38	052-0028	Wrist Pin, High Pressure	2				
39	047-0054	Connecting Rod Assy., Alum.	4				
40	051-0055	Bearing Insert (2 pieces)	4				
41	090-0018	Breather Flange	1				
42	090-0690	Elbow	2				
43	054-0119	Retaining Ring	4				
44	054-0126	Ring Set, Low Pressure	2				
45	048-0054	Piston, Low Pressure	2				
46	052-0027	Wrist Pin, Low Pressure	2				
47	060-0063	Washer, Copper, .66ODx.39ID	12				
48	059-0159	Bolt, Cylinder, M10x30mm	12				
49	082-0013	Aftercooler	1				

PUMP SPECIFICATIONS

Weight.....309 Lbs.
 Oil :.....C-Aire Special Air Compressor(Non Detergent)
 or Other Low Carbon Compressor Oil

Maximum RPM.....800 RPM
 Crankcase Oil Capacity.....65 Oz.
 Oil Change Schedule.....200 to 300 Hours

TORQUE SPECIFICATIONS

Aftercooler.....14-19 ft.lb.
 Flywheel.....47-57 ft.lb.
 Rod.....34-37 ft.lb.
 Vaive.....9-12 ft.lb.

Bearing Carrier.....14-19 ft.lb.
 Head.....32-37 ft.lb.
 Sight Glass.....14-19 ft.lb.
 Valve Cover.....14-19 ft.lb.

Cylinder.....19-27 ft.lb.
 Intercooler.....14-19 ft.lb.
 Unloader Cover.....9-12 ft.lb.
 Valve Retainers.....65-70 ft.lb.